

Exhibition Proposals 2022

Brimbank Galleries

Applications are now open for our 2022 Exhibition Program.

Brimbank City Council invites artists/curators/groups to submit proposals to exhibit as part of our 2022 exhibition program at the following galleries;

Bowery Gallery - St Albans Community Centre
Sunshine Art Spaces Gallery
Projection Wall – Brimbank Community & Civic Centre

Council provides exhibition space at no charge to exhibit a series of works in a gallery space. Each exhibition lasts approximately 6-8 weeks.

The exhibition program forms part of Council's effort to foster the cultural life of the community. The Council will build on the municipality's cultural diversity to foster a vibrant community and a creative environment.

Who can apply?

We are interested to receive solo or group exhibition proposals from established and emerging artists working across a broad range of visual arts practice including painting, drawing, contemporary textile, new media, photography and installation work.

We particularly encourage artists from the western region of Melbourne and artists from diverse cultural backgrounds to apply.

Proposals that relate to community events such as MidSumma, Reconciliation Week, Refugee Week, International Day of People with a Disability, for example, will be highly regarded.

Applications close Monday 20 September 2021 at 5pm

For further information or to discuss the application process please contact:

Michael Shiell
Visual and Public Arts Officer
Brimbank City Council
T (03) 9249 4613
E artspaces@brimbank.vic.gov.au

Lisa Horsburgh
Art Spaces Officer
Brimbank City Council
T (03) 9249 4397
E artspaces@brimbank.vic.gov.au

Gallery Spaces

Creative Brimbank offers a range of exhibition spaces across the municipality. These spaces provide different functions and allow for a breadth of experiences for both the artist and audiences alike. Through this program local and emerging artists are given the chance to exhibit their creative works for others to come and enjoy.

We recommend to visit the spaces in advance before submitting your proposal to ensure your proposal is suited to the venue.

Sunshine Art Spaces Gallery



Sunshine Art Spaces Gallery is located in walking distance from Sunshine train station at 2 City Place, Sunshine.

Inclusive space for emerging artists. Scope for projection, sculptural and installation works.

This Gallery is not staffed by council officers, it relies on exhibitors to open the space to the public. All exhibitors will be inducted into the gallery prior to installation of works.

Bowery Gallery



The Bowery Gallery is located in the heart of St Albans at the St Albans Community Centre. It is in walking distance from the train station, situated at the end of Princess Street, St Albans. This space supports established and experimental artists. This gallery is best suited for secure works only. Video work option is also available.

Opening Hours

Council run facility open Monday to Friday 9am to 5pm, Saturday 9am to 12:30pm. Closed Public Holidays.

Projection Wall – Brimbank Community & Civic Centre



In a Brimbank first, we now have an outside gallery for projecting artworks as part of the Light up Sunshine project. The projection wall is located behind the Brimbank Community & Civic Centre in Sunshine.

Artists' work will be displayed in the evenings from 7pm at this location for two month periods as part of the rotational gallery of projections.

Selection Process

All applications will be reviewed and selected by a Selection Panel, including two members of Brimbank City Council's Arts and Culture Unit.

Applications will be prioritised primarily depending on their suitability for the space and judged according to the selection criteria. Decisions will be made based on the submitted exhibition application.

Selection Criteria

Exhibition proposals will be judged against the following criteria:

- Applicants must be at least 18 years old or be supervised by a suitable organisation;
- Local artists' applications (those that work or reside within the Brimbank City Council municipality) are considered favourably but broader applications are also welcome;
- Clarity of theme/concept of the exhibition proposal;
- The potential and creative talent of the applicant;
- The potential of the applicant to contribute to Brimbank's reputation as an emerging arts location;
- The suitability of the applicant to match the space, including any OHS considerations of the space;
- The mix and diversity of artists, art forms across the exhibition calendar;
- The availability of viable alternatives for the applicant in Brimbank.

Terms and Conditions

Exhibition Agreement

Successful applicants must return a signed copy of their agreement no later than two weeks after their exhibition proposal has been accepted.

Costs

Use of the gallery is at no charge. If an artist sells their work a 10% commission on sales is charged. Brimbank City Council will issue an invoice for the amount to the artist or in the case of group shows, to the nominated artist, at the end of the exhibition.

Signage, labels and printed materials

Exhibitors are responsible for providing high resolution images to be used in all promotional materials. Council Officers will create invitations and labels using the approved Council templates. These materials will be provided electronically for digital distribution via email. Council will provide Vinyl lettering for the title signage for exhibitions at The Bowery Gallery and Sunshine Art Spaces Gallery.

Marketing and promotion

Exhibitions are promoted through the Creative Brimbank website, social media channels and Council email lists. The exhibitor is responsible for all other marketing and promotion, subject to the 'Media' clause below.

Media

All contact with media (i.e. newspapers, magazines, radio and television) must be conducted through Council's Media and Communications Department working through the Art Spaces Officer.

Equipment

The Gallery has a track hanging system. A limited number of Plinths are available for use or can be supplied by the exhibitor. A basic tool box and a step ladder are available to exhibitors and must remain in the Gallery. Trestle tables and chairs are also available. Works may be displayed using the gallery's TV screen at Bowery Gallery or via two projectors at Sunshine Art Spaces Gallery. Use of council equipment is subject to availability and to be discussed with and approved by the Curatorial Team.

Installation

The curatorial team will work in collaboration with the artist to install the exhibition. Works do not need to be framed however all work does need to be ready to hang when it is delivered to the gallery. If your work is framed it must have hanging fixtures on the back such as D-rings and / or a hanging wire. Unframed works must also have a hanging solution such as blu-tac, 3M Velcro tabs or pins. The use of nails, pins, sticky tape, etc. which damages walls and plinths, is not permitted. The painting of the Gallery walls is not permitted. The Curatorial Team have the right to omit works deemed inappropriate, unsafe or unfinished. All installations must occur within the hire period and must be completed by the agreed exhibition opening date.

De-install

Exhibitions are to remain on display for the agreed duration. De-installation should occur the day after the exhibition has closed and within the agreed hire period. All artwork and items belonging to the exhibitor must be removed from the space by the end of the agreed hire period. De-install is the responsibility of the exhibitor. The space must be left in its original condition.

Exhibition Opening

Each exhibitor is able to arrange an official opening for their exhibition. The exhibitor is liable for all costs involved including any catering provisions required and food and beverages cannot be sold. Alcohol may be served on the provision that there will be a representative present who has obtained a Responsible Service of Alcohol certificate.

Opening Hours

The Bowery Gallery is staffed during opening hours (the Gallery is closed on public holidays). Sunshine Art Spaces Gallery is an artist run space. We request that the Gallery is open to the public at least two to three days per week, hours by negotiation. **The exhibitor is responsible for staffing the Sunshine Art Spaces Gallery during opening hours.** Exhibitors will be issued with a key and alarm code for the space and exhibitors are responsible for ensuring that the space is secure upon leaving. Sunshine Art Spaces Gallery exhibitors are required to keep the space, including kitchen, outdoor area and bathroom, if used, in a reasonable condition. Please ensure that dishes are washed for example and that fridge contents are removed at the end of the hire period.

Insurance Liability Disclaimer

Brimbank City Council will not be held responsible for any loss or damage to artworks (during transportation, display or storage), or personal injury to Gallery exhibitors. Exhibitors are advised to take out personal accident cover and insurance to cover loss or damage to artworks during transportation, storage and exhibition.

How to apply

Artists and Curators who may wish to apply and who have difficulties with written English may contact the Visual and Public Arts Officer to make an appointment to seek assistance with their application on 9249 4600.

Applicants must include in their proposal:

1. Application Form

- A fully completed online application form.
- For groups, please identify one person to be the contact

2. Exhibition Proposal

- A clear description of the exhibition concept, artwork, medium, themes, rationale, target audience

3. Artist(s) CV

- Include name, current and relevant art information, other exhibitions, awards, etc
- No longer than one A4 page for each artist if applying as a group

4. Visual Support

- For an individual: Images of current work that you propose to exhibit
- For a group: one to two images of current work that you propose to exhibit per artist
- List of works
- NB. Images should be high quality JPEG images, each image clearly titled

Sunshine Art Spaces Gallery Floorplan

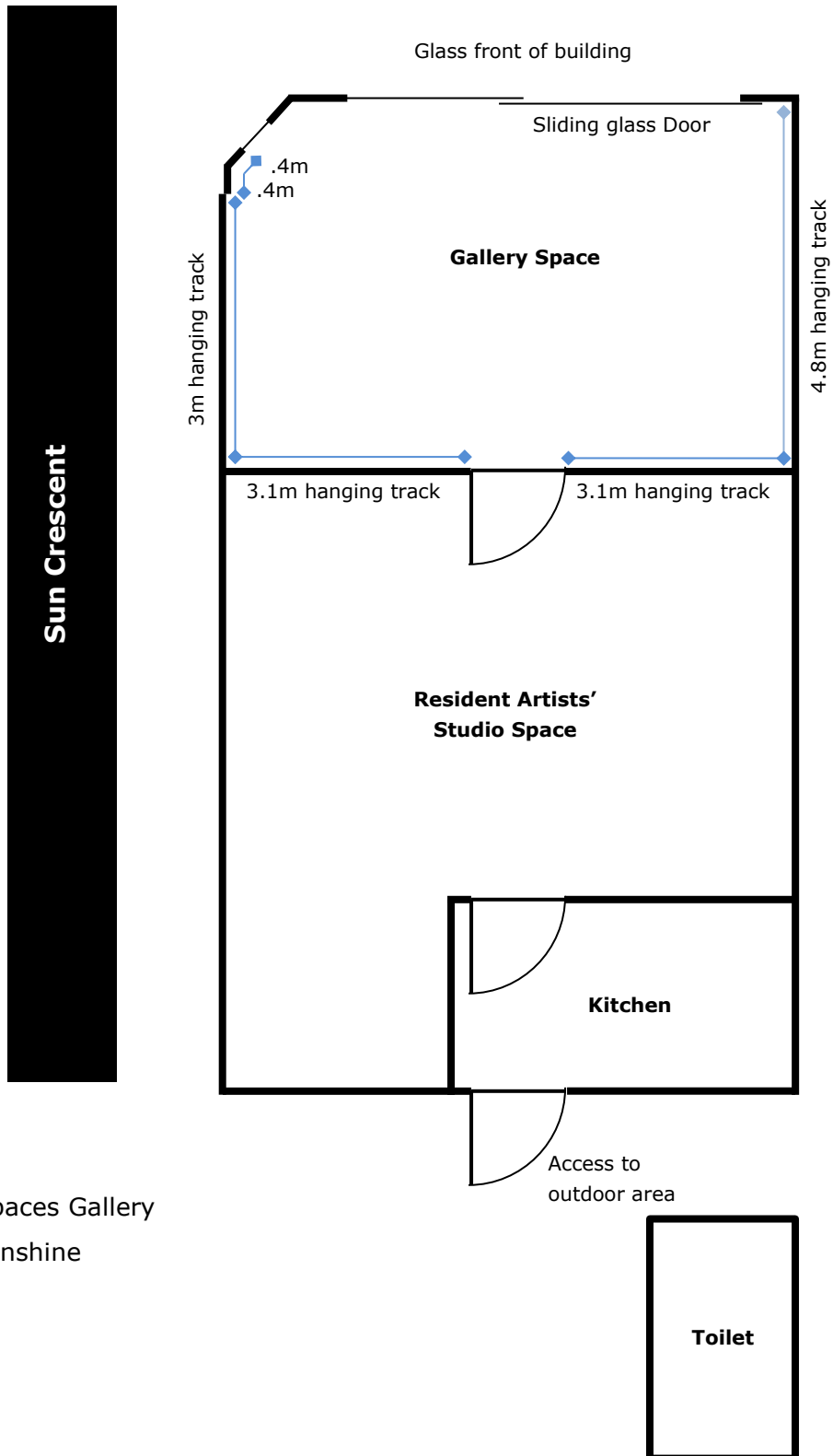

Gallery address
Sunshine Art Spaces Gallery
2 City Place, Sunshine
VIC 3020

Bowery Gallery Floorplan

Gallery Address

St Albans Community Centre
33 Princess Street, St Albans
VIC 3021

